

VUEPOINT™

Assembly Instructions for Model: HTBSW

Thank you for choosing a VUEPOINT™ HTBSW. The HTBSW consists of two Speaker Stands and three Speaker Wall Mounts. The HTBSW Speaker Wall Mount Assembly Instructions are covered in Section 1 of this manual while the HTBSW Speaker Stands are covered in Section 2.

If you do not understand these directions, or have any doubts about the safety of the installation, please call a qualified contractor or contact CSAV at 800.359.5520 or www.vuepointav.com. Our customer service representatives can quickly assist you with installation questions and missing or damaged parts. Replacement parts for products purchased through authorized dealers will be shipped directly to you. Check carefully to make sure that there are no missing or defective parts. CSAV can not be liable for damage or injury caused by incorrect mounting, incorrect assembly, or incorrect use. Please call CSAV before returning products to the point of purchase.

SECTION 1 - HTBSW Wall Mount Assembly Instructions

▲CAUTION:

The weight of the speaker must not exceed 4 Lbs [1.8 Kg]. The wall must be capable of supporting five times the weight of the speaker plus the wall mount. Never use defective parts. Improper installation may cause property damage or personal injury. Do not use this product for any purpose that is not explicitly specified by CSAV.

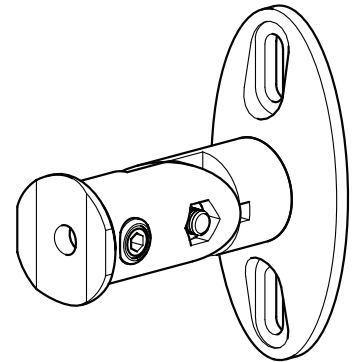

Required Tools: Drill, 7/64" drill bit, 5/16" masonry drill bit, philips screw driver

Supplied Parts and Hardware: (Threaded fasteners are shown actual size.)

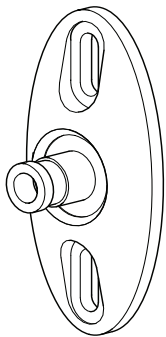

Wall Plate/Speaker Bracket - A
Qty. 6

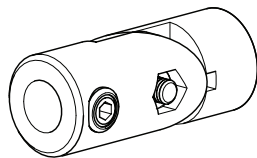

Elbow - B
Qty. 3

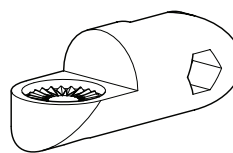

Extension - C
Qty. 3

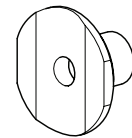

Speaker Bracket - D
Qty. 3



M6 x 20mm Cap Screw - E
Qty. 3



M6 Nut - F
Qty. 3



Allen Key - G
Qty. 1

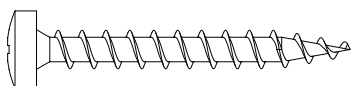

#12 x 1-5/8" Wood Screw - H
Qty. 6

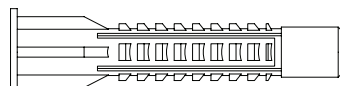

Anchor - I
Qty. 6

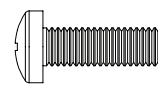

M5 x 16mm Screw - J
Qty. 6

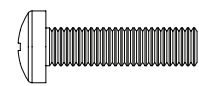

M5 x 20mm Screw - K
Qty. 3

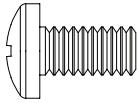

1/4-20 x 1/2" Screw - L
Qty. 6

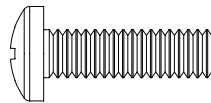

1/4-20 x 7/8" Screw - M
Qty. 3



8-32 x 5/8" Screw - N
Qty. 3



8-32 Keyhole Nut - O
Qty. 3

Step 1: Mounting the Wall Plate.

Wood Stud Mounting.

▲ CAUTION:

Do not overtighten the Wood Screws (H). Tighten the Wood Screws only until they are pulled firmly against the Wall Plate/Speaker Bracket (A). If there is a layer of drywall or other material, this material may not exceed 5/8 inch [15.8mm] in thickness. Failure to heed this caution may result in property damage and/or personal injury.

Use a high quality stud sensor to locate the stud. It is recommended that you verify the stud location with an awl or nail.

Use the Wall Plate/Speaker Bracket (A) as a template, and pre-drill two holes 1.5" [38.1mm] deep into the stud, using a 7/64" drill bit.

Orient the Wall Plate/Speaker Bracket (A) as shown in Diagram 1A; then, using the #12 x 1-5/8" Wood Screws (H), secure the Wall Plate/Speaker Bracket to the wall.

Diagram 1A

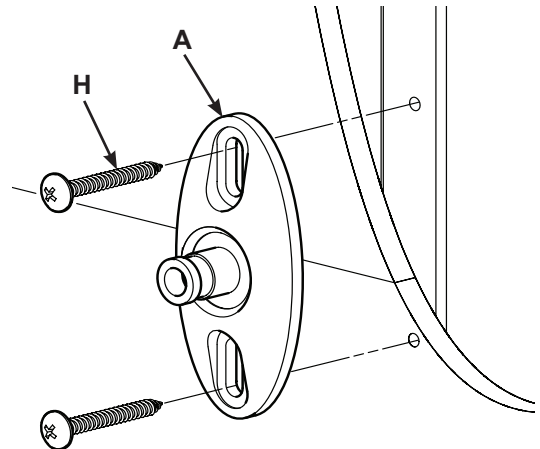

Brick, Solid Concrete, or Concrete Block Mounting.

▲ CAUTION:

Always locate Anchors (I) in the brick, block, or concrete. Never drill into the mortar between blocks. Make sure the Anchors are seated flush with the concrete surface, even if there is a layer of drywall or other material. This drywall or other material may not exceed 5/8 inch [15.8mm] in thickness. Failure to heed this caution may result in property damage and/or personal injury.

Use the Wall Plate/Speaker Bracket (A) as a template, and pre-drill two holes 1.5" [38.1mm] deep using a 5/16 inch masonry bit. Insert an Anchor (I) into each hole, making sure they are completely seated and flush with the concrete surface, even if there is a layer of drywall or other material in front of the concrete.

Orient the Wall Plate/Speaker Bracket (A) as shown in Diagram 1B; then, using the #12 x 1-5/8" Wood Screws (H), secure the Wall Plate to the wall.

Diagram 1B

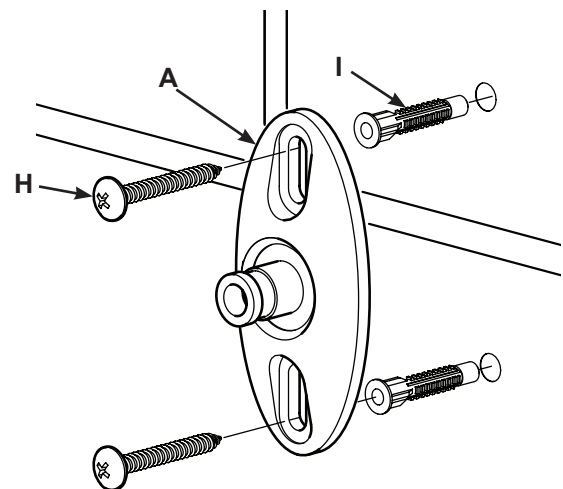

Step 2: Elbow Configuration.

NOTE:

The Elbow (B) is shipped fully assembled. If desired, the Extension (C) may be used to lengthen or extend the distance of your speakers from the wall.

Using the Allen Key (G), remove the M6 x 20mm Cap Screw and M6 Nut, thus separating the two ends of the Elbow (B) as shown in Diagram 2A.

Align the Extension (C) with one half of the Elbow (B) so that the teeth on the two mesh; then, secure them using a M6 x 20mm Cap Screw (E) and M6 Nut (F) as shown in Diagram 2B. Repeat this procedure for the second half of the Elbow (B) as shown in Diagram 2B.

Diagram 2A

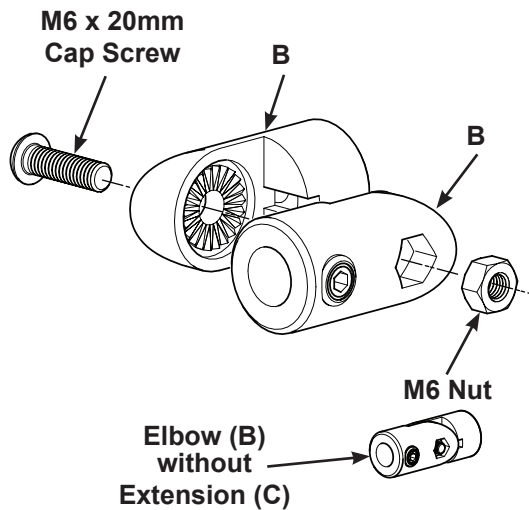
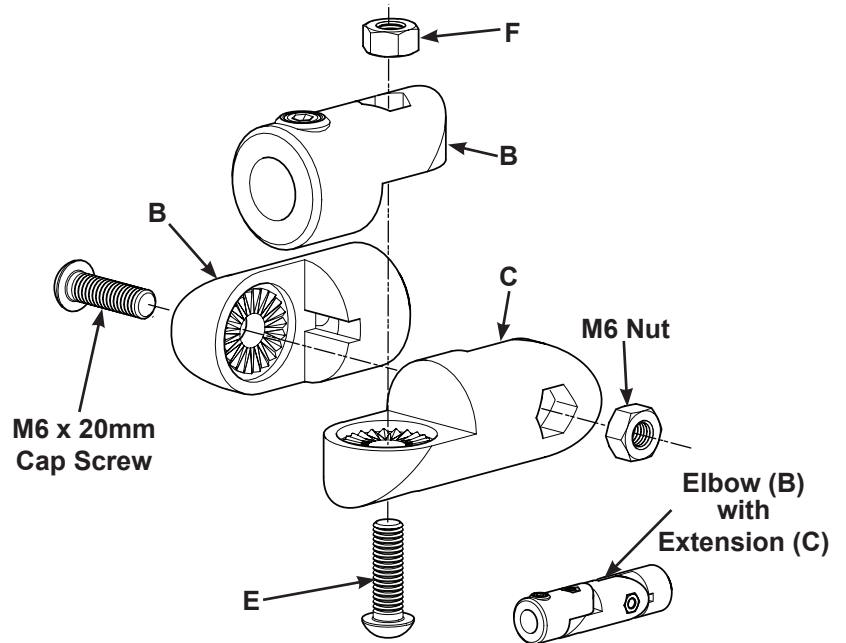

Diagram 2B



Step 3: Secure Elbow to Wall Plate.

CAUTION:

Make sure the Set Screw is tight, but not over tight, when securing the Elbow (B) to the Wall Plate/Speaker Bracket (A). Tighten the Set Screw until the connection between the Wall Plate/Speaker Bracket (A) and Elbow (B) is secure.

Using the Allen Key (G), loosen the Set Screw on the side of the Elbow (B) closest to the Wall Plate/Speaker Bracket (A); then, slide the Elbow onto the Wall Plate/Speaker Bracket and retighten the Set Screw as shown in Diagram 3.

Diagram 3

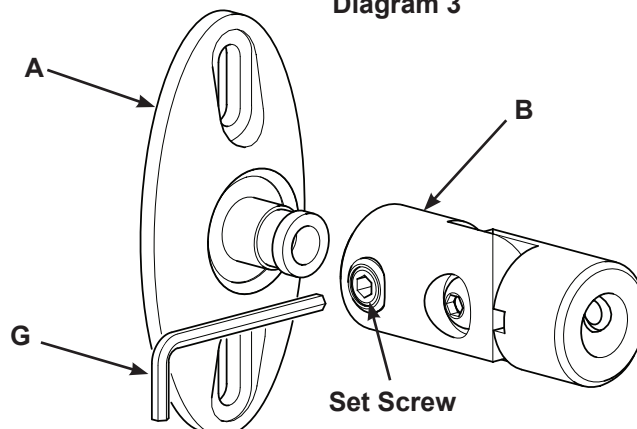

NOTE:

Determine if you will be mounting the speaker to the Wall Plate/Speaker Bracket (A) or the Speaker Bracket (D). Speakers with dual threaded inserts on the back will require the Wall Plate/Speaker Bracket. Speakers with single threaded inserts or keyhole mounting will require the Speaker Bracket.

Step 4: Mounting a Speaker with two Threaded Inserts to the Wall Plate/Speaker Bracket.

NOTE:

1/4-20 x 1/2", and M5 x 16mm Screws (J,L) are provided. Other sizes are available from you local hardware store.

Determine the diameter and length of the Screw (J,L) your speaker requires by hand threading them into the insert on the back of the speaker. If you encounter any resistance stop immediately.

Once you have determined the correct diameter and length, thread the Screw (J,L) through the Wall Plate/Speaker Bracket (A) and into the speaker as Shown in Diagram 4.

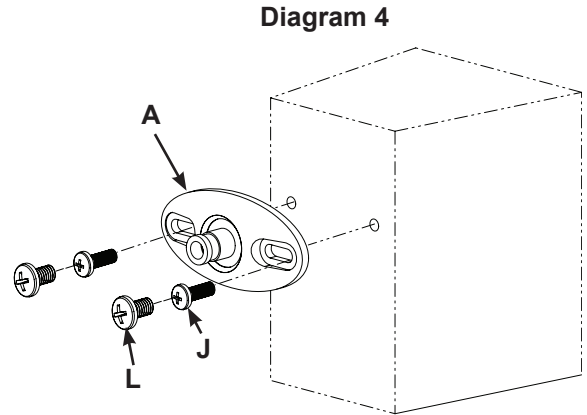

Step 5: Mounting a Speaker with one Threaded Insert to the Speaker Bracket.

NOTE:

M5 x 16mm, M5 x 20mm, 1/4-20 x 1/2", 1/4-20 x 7/8" , and 8-32 x 5/8" Screws (J, K, L, M, N) are provided. Other sizes are available from you local hardware store.

Determine the diameter and length of the Screw (J, K, L, M, or N) your speaker requires by hand threading them into the insert on the back of the speaker. If you encounter any resistance stop immediately.

Once you have determined the correct diameter, thread the Screw (J, K, L, M, or N) through the Speaker Bracket (D) and into the speaker as Shown in Diagram 5A.

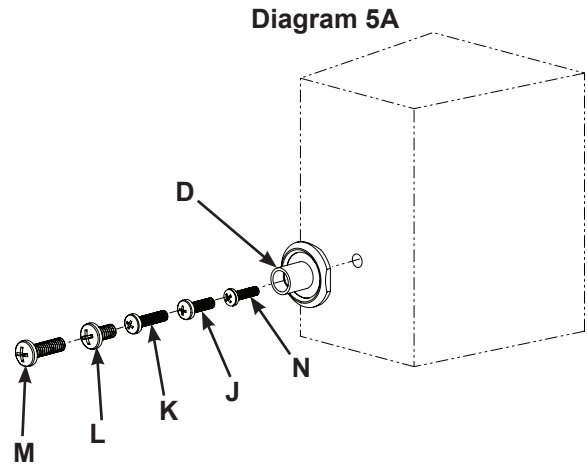

NOTE:

If the 8-32 x 5/8" Screw (N) is too long, use the 8-32 Keyhole Nut (O) as a spacer as shown in Diagram 5B

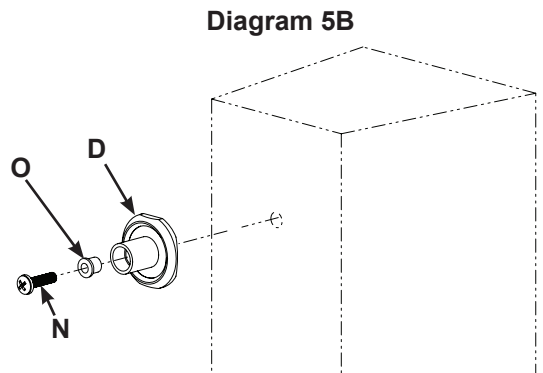

Step 6: Mounting a Speaker with a Keyhole to the Speaker Bracket.

Place the 8-32 x 5/8" Screw (N) through the Speaker Bracket (D); then, partially thread the 8-32 Keyhole Nut (O) onto the 8-32 x 5/8" Screw as shown in Diagram 6.

Insert the 8-32 Keyhole Nut (O) into the speaker and tighten the 8-32 x 5/8" Screw (N) to secure the Speaker Bracket (D) to the speaker as shown in Diagram 6.

Diagram 6

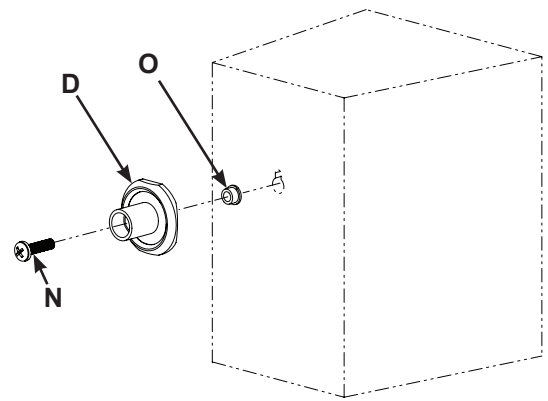

Step 7: Attaching the Speaker with Wall Plate/Speaker Bracket or Speaker Bracket to the Elbow.

NOTE:

For clarity, only the Speaker Bracket (D) without a speaker is shown in Diagram 7.

Using the Allen Key (G), loosen the Set Screw on the side of the Elbow (B) as shown in Diagram 7.

CAUTION:

Make sure the Set Screw is tight, but not over tight, when securing the Elbow (B) to the Wall Plate/Speaker Bracket (A) or the Speaker Bracket (D). Tighten the Set Screw until the connection between the Wall Plate/Speaker Bracket or the Speaker Bracket and Elbow (B) is secure.

Insert the Wall Plate/Speaker Bracket (A) or Speaker Bracket (D), with the speaker attached, into the Elbow (B) and retighten the Set Screw as shown in Diagram 7.

Diagram 7

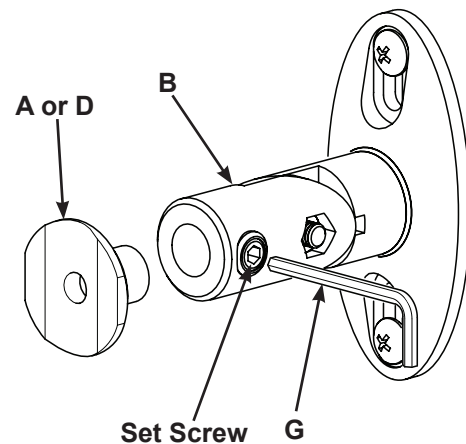

SECTION 2 - HTBSW Speaker Stand Assembly Instructions

▲ CAUTION:

The weight of the speaker must not exceed 4 Lbs [1.8 Kg]. Never use defective parts. Improper installation may cause property damage or personal injury. Do not use this product for any purpose that is not explicitly specified by CSAV.

Required Tools: Philips screw driver

Supplied Parts and Hardware: (Threaded fasteners are shown actual size.)

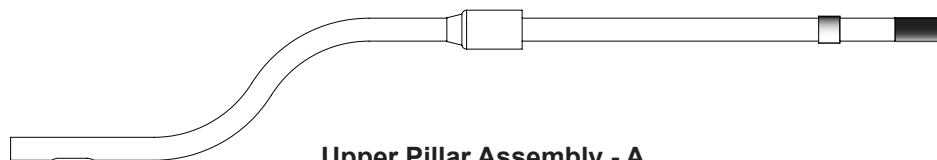

Upper Pillar Assembly - A
Qty. 2

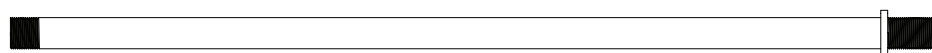

Lower Pillar Assembly - B
Qty. 2

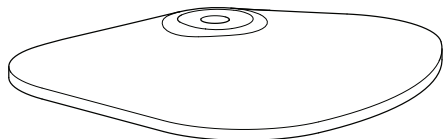

Base - C
Qty. 2

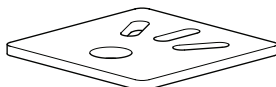

Top Plate - D
Qty. 2

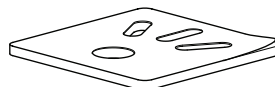

Double Stick Pad - E
Qty. 2

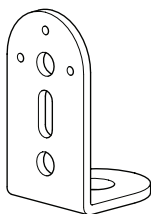

L-Bracket - F
Qty. 2

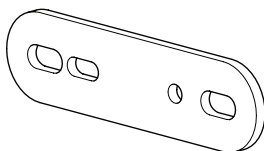

Double Bolt Bracket - G
Qty. 2

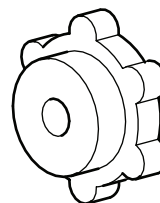

Knob - H
Qty. 2

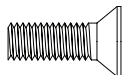

M5 x 15mm Bolt - I
Qty. 2

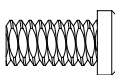

Key Hole Bolt - J
Qty. 2

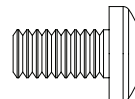

1/4 x 20 x 1/2" Bolt - K
Qty. 4

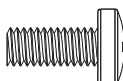

M5 x 12mm Bolt - L
Qty. 4



Felt Pad - M
Qty. 6

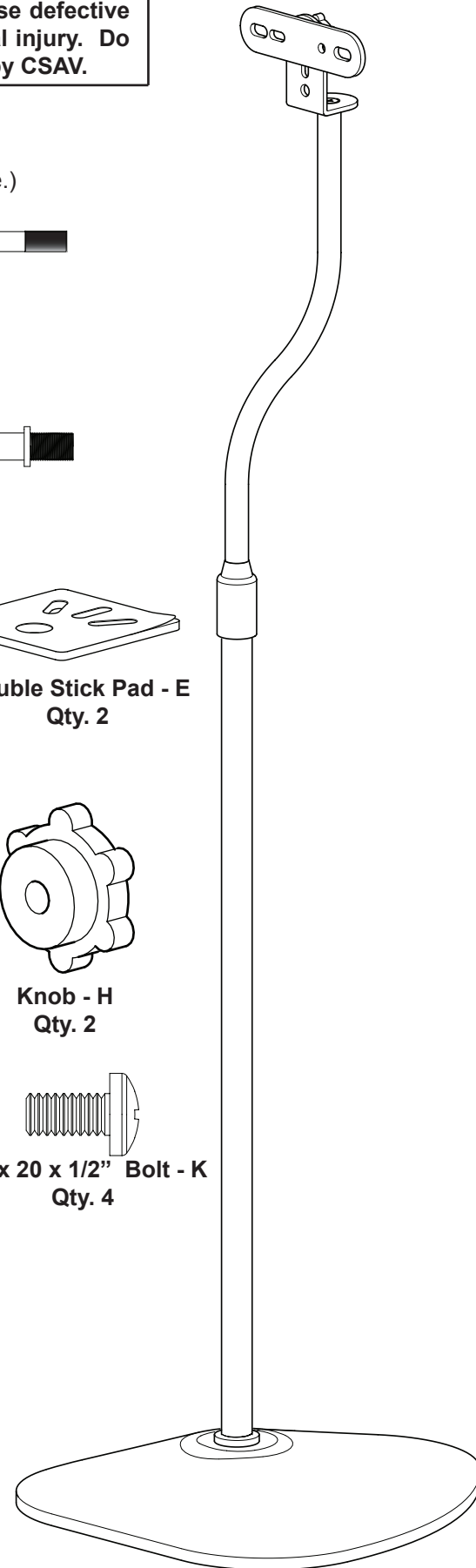

Step 1: Attach Felt Pads to Base.

Remove the backing material from the Felt Pads (**M**) and press them onto both Bases (**C**) as shown in Diagram 1.

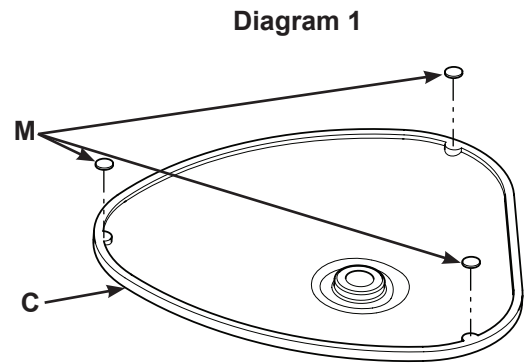

Step 2: Attach Lower Pillar Assembly to Base.

Screw the Lower Pillar Assembly (**B**) with the Base Nut down, into the Base (**C**) as shown in Diagram 2.

Tighten the Base Nut to lock the Lower Pillar Assembly (**B**) to the Base (**C**) as shown in Diagram 2.

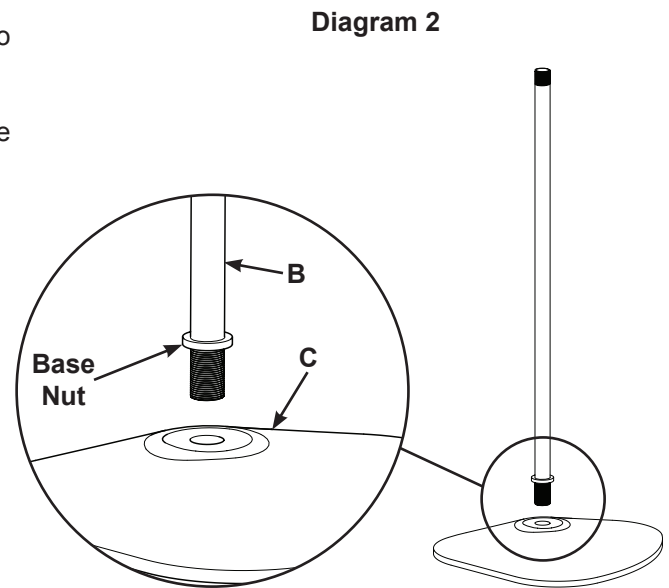

Step 3: Attach Upper Pillar Assembly to Lower Pillar Assembly and Base.

NOTE:

Make sure the Pole Retaining Ring is on the Upper Pillar Assembly (A) and under the Plastic Connector.

Slide the Upper Pillar Assembly (**A**) down into the Lower Pillar Assembly (**B**) as shown in Diagram 3.

Align the Upper Pillar Assembly (**A**) so that the slotted speaker wire hole near its top is toward the back of the Base (**C**) as shown in Diagram 3.

Tighten the Plastic Connector to hold the Upper Pillar Assembly (**A**) at the desired height as shown in Diagram 3.

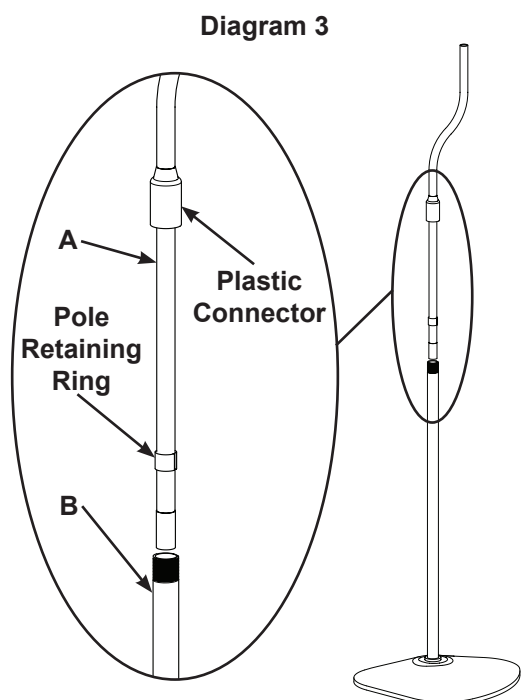

NOTE:

Follow the procedure below that best matches your speaker. The hardware provided is for the most common speakers. Other hardware may be required and can be found at your local hardware store.

Step 4: Speakers with no Threaded Insert, or a Bottom Threaded Insert.

NOTE:

Orient the Top Plate (D) and Double Stick Pad (E) to the Upper Pillar Assembly (A) as shown in Diagram 4A.

Place the M5 x 15mm Screw (I) through the Top Plate (D) and screw it into the top of the Upper Pillar Assembly (A) as shown in Diagram 4A.

If you wish to use the Double Stick Pad (E). Remove the backing paper from one side of the Double Stick Pad, making sure the slotted holes are aligned with the Top Plate (D); then, attach the Double Stick Pad to the Top Plate as shown in Diagram 4A.

NOTE:

The 1/4-20x1/2" Bolt (K) and M5 x 12mm Bolt (L) are provided, other sizes may be found at you local hardware store.

If the Speaker has a bottom bolt attachment, make sure the threaded hole lines up with one of the slots on the Top Plate (D) and Double Stick Pad (E).

NOTE:

If there are no threaded holes, simply peel back the backing paper from the Double Stick Pad (E) and secure the speaker to the Top Plate (D) as shown in Diagram 4B.

Peel back the backing paper from the Double Stick Pad (E); then, using the Bolt (K), secure the speaker to the Top Plate (D) and Double Stick Pad as shown in Diagram 4B.

Diagram 4A

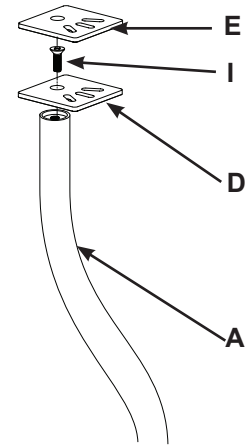
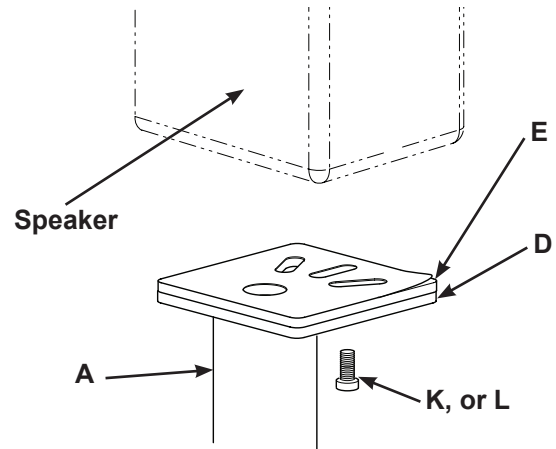

Diagram 4B



Step 5: Speakers with one or two Threaded Inserts on the Back.

NOTE:

Orient the L-Bracket (F) to the Upper Pillar Bracket Assembly (A) as shown in Diagram 5.

Place the M5 x 15mm Screw (I) through the L-Bracket (F) and screw it into the top of the Upper Pillar Assembly (A) as shown in Diagram 5

Diagram 5

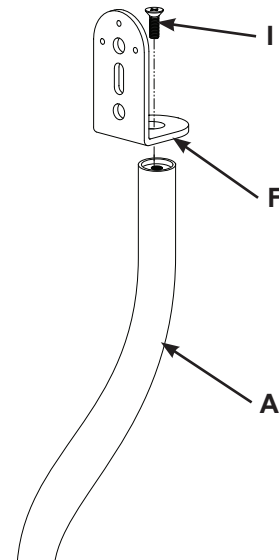

Step 6: Attach Speakers with a Single Threaded Insert.

NOTE:

The 1/4-20x1/2" (K) and M5 x 12mm (L) Bolts are provided, other sizes may be found at you local hardware store.

Determine the correct Bolt (K, or L) to use by threading it into the back of the speaker. Stop immediately if any resistance is felt.

Using the Bolt selected (K, or L), secure the speaker to the L-Bracket (F) as shown in Diagram 6.

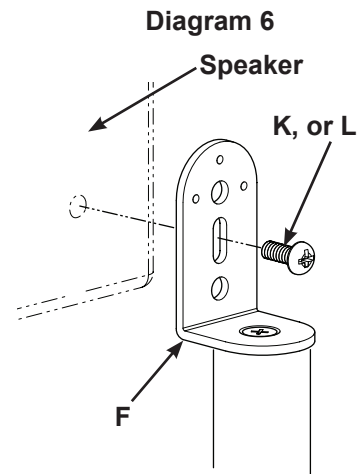

Step 7: Attach Speakers with a Double Threaded Insert.

Using the Knob (H), attach the Double Bolt Bracket (G) to the L-Bracket (F) as shown in Diagram 7

NOTE:

The 1/4-20x1/2" (K) and M5 x 12mm (L) Bolts are provided, other sizes may be found at you local hardware store.

Determine the correct Bolt (K, or L) to use by threading it into the back of the speaker. Stop immediately if any resistance is felt.

Using the Bolt selected (K, or L), secure the speaker to the Double Bolt Bracket (G) as shown in Diagram 7.

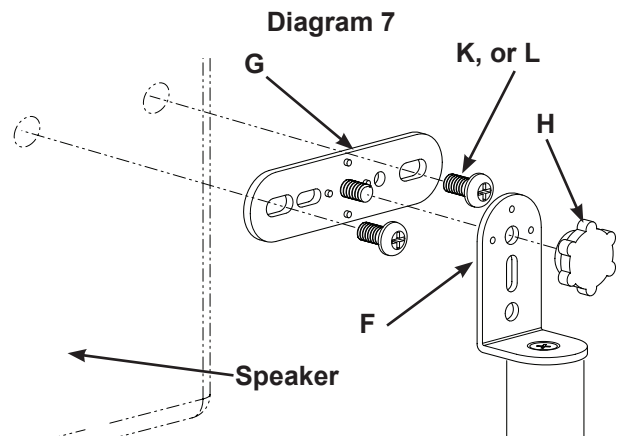

Step 8: Attach Speakers with a Key Hole Slot.

Insert the Key Hole Bolt (J) through slotted opening of the L-Bracket (F) and thread it onto the Knob (H) as shown in Diagram 8.

Slide the Speaker down onto the Key Hole Bolt (J); then, tighten the Knob (H) to secure the speaker to the Speaker Stand as shown in Diagram 8.

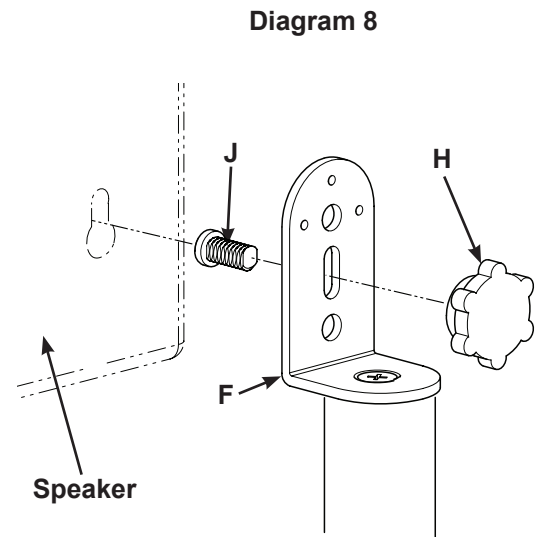

Step 9: Route Speaker Wires.

CAUTION:

Disconnect the Speaker Wire from the receiver or amplifier when you route it through the Upper and Lower Pillar Assembly (A & B) and out through the Base (C) to avoid damage to the speakers, amplifier, or receiver.

Insert the Speaker Wire into the Slotted Hole in the Upper Pillar Assembly (A), down through the pillars, and out through the two grooves in the Base (C) as shown in Diagram 9.

